

TŌYŌTŌMI

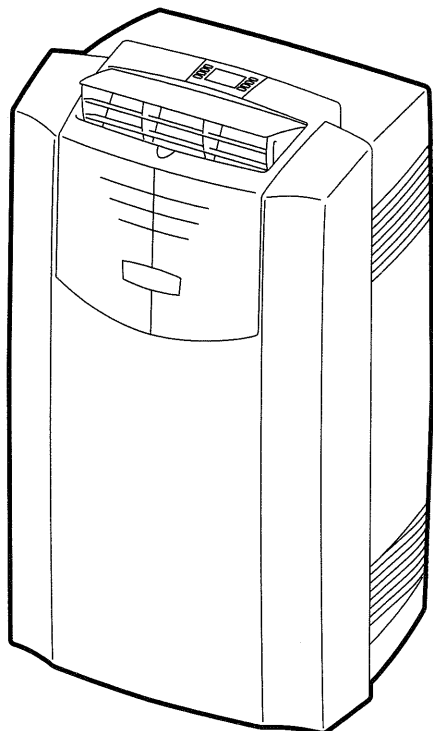

PORTABLE AIR CONDITIONER

**ACONDICIONADOR DE AIRE
PORTATIL**

**CONDITIONNEUR D'AIR
DEPLACABLE**

TAD-T32G



**INSTRUCTION MANUAL
MANUAL DE INSTRUCCIONES
MODE D'EMPLOI**

**ENGLISH P. 1
ESPAÑOL P. 7
FRANCAIS P. 13**

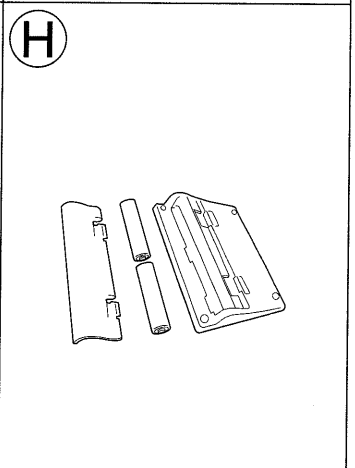
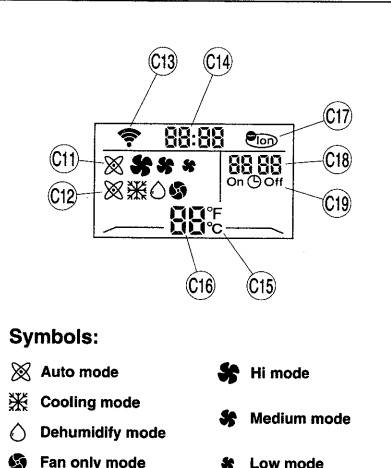
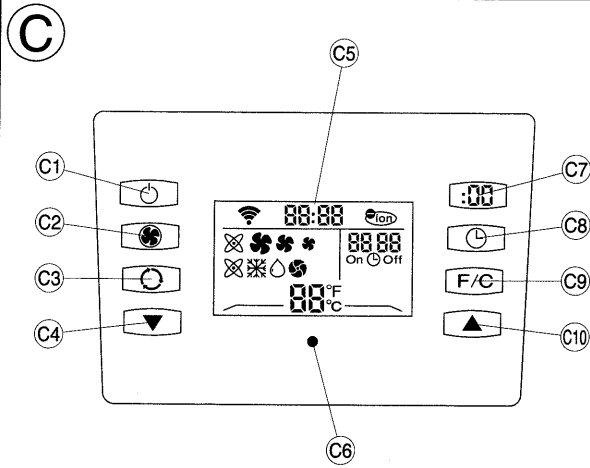
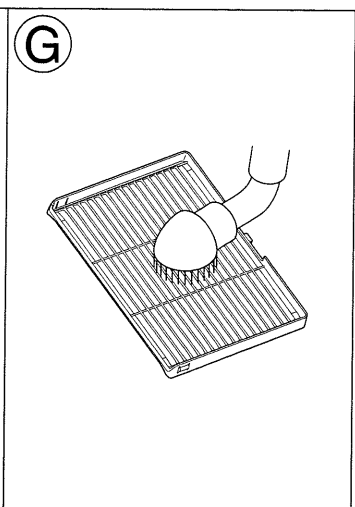
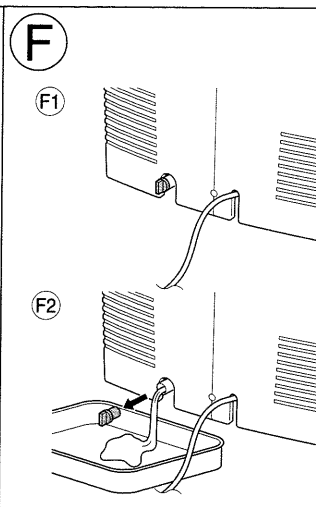
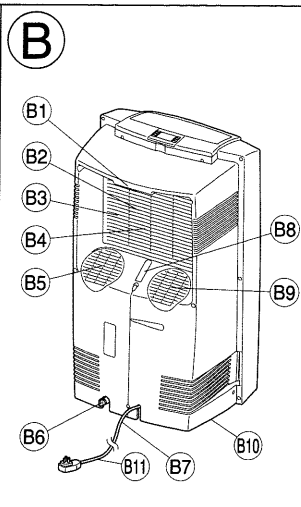
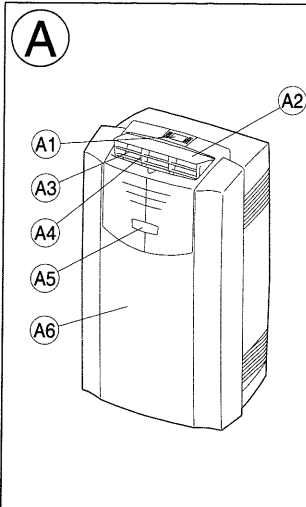

- Symbols:**
- ⊗ Auto mode
 - ⊗ Cooling mode
 - ⊖ Dehumidify mode
 - ⊗ Fan only mode
 - ⊗ Hi mode
 - ⊗ Medium mode
 - ⊗ Low mode

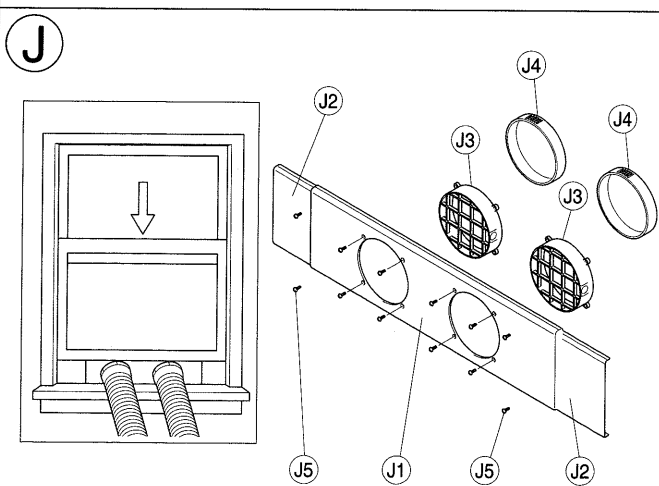
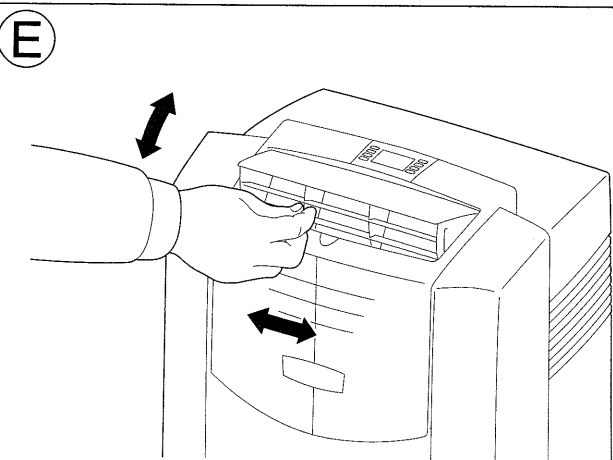
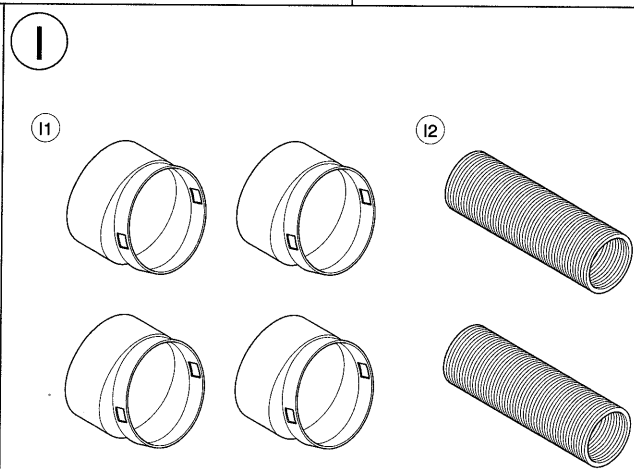
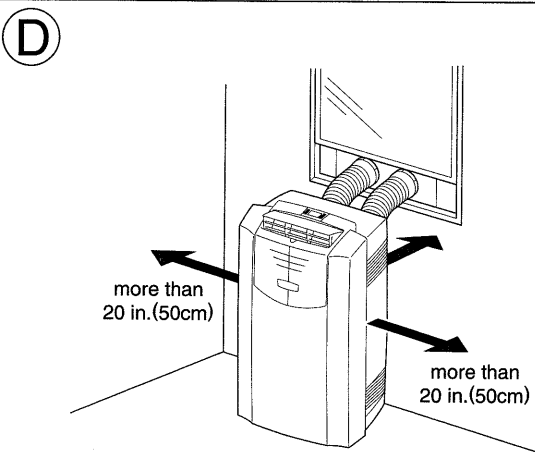

SUMMARY

The idea behind the unit is to provide a localized supply of cool air. The unit will greatly enhance your personal comfort whether at a work station or even in your favorite chair.

Four (4) casters enable you to move the unit easily from room to room. It cools and dries the air at the same time so that you can stay comfortable even when it's humid or rainy outside. Also your furnishings and fabrics are kept in good condition when it's used as a dehumidifier.

Conventional air conditioners use large quantities of energy to cool an entire room, including walls and furniture. The unit creates a zone of cool and dry air only where it is needed. It does not waste energy cooling the surroundings.

It's easy to operate. Once you set the desired function, all functions will be memorized in the unit. The built-in timer allows from 1 to 12 hours operation, where the unit is automatically turned on and off. This is especially convenient at bedtime.

Venting is not required. However, if the unit is to be used exclusively in one space, the cooling efficiency will be enhanced by using the venting kit accessory.

OPERATIONAL FEATURES

1. COOLING OPERATION

Normally, cool air is directed out the front louvers by the circulation fan which has three (3) stages of fan speed.

2. AUTOMATIC OPERATION

Once the desired function has been set, it is memorized as long as it remains connected to the wall outlet. In the event of a power failure, the desired function must be re-entered when power is restored..

3. THERMO CONTROL

The compressor will automatically shift to ON or OFF to maintain the desired temperature.

4. TIMER OPERATION

The unit will turn on and off after the designated period of time (1, 2, 3, ...12 hours).

5. AUTOMATIC SHUT-OFF MECHANISM WHEN DRAIN TANK IS FULL

When the drain tank is full, the unit will be automatically shut off. It is always required to press power button twice to resume operation after the condensed water is removed from the tank.

6. TRIPLE AIR FILTERS

A pre-filter protects the unit from dust, HAF filter cleans circulation air and a charcoal filter eliminates unpleasant odor.

1. DESCRIPTION

Fig. A FRONT

- A1 Remote control (Removable)
- A2 Air outlet grille
- A3 Horizontal louver
- A4 Vertical louver
- A5 Emergency ON/OFF switch
- A6 Front panel

Fig. B REAR

- B1 Air intake grille
- B2 HAF filter (inside)
- B3 Charcoal filter (inside)
- B4 Filter clamp (inside)
- B5 Air intake opening
- B6 Drain water outlet
- B7 Power supply cord
- B8 Cable hook
- B9 Exhaust outlet
- B10 Caster
- B11 LCDI Power plug

Fig. C REMOTE CONTROL (REMOVABLE)

- C1 Power button
- C2 Fan speed button
- C3 Mode button
- C4 Down button
- C5 LCD display
- C6 Reset switch
- C7 Clock button
- C8 Timer button
- C9 C/F toggle button

- C10 UP button
- C11 Fan speed indicator
- C12 Mode indicator
- C13 Launch signal indicator
- C14 Clock indicator
- C15 C/F indicator
- C16 Set temp indicator
- C17 Negative ion indicator
- C18 Timer setting indicator
- C19 Timer ON/OFF indicator

Fig. I EXHAUST DUCT SET

- I1 Exhaust duct hose connector (4 pcs.)
- I2 Exhaust duct hose (2 pcs.)

Fig. J WINDOW PANEL KIT

- J1 Window panel "C"
- J2 Window panel extension (2 pcs.)
- J3 Exhaust duct hose grille (2 pcs.)
- J4 Cover (2 pcs.)
- J5 Screws

2. SAFETY TIPS

IMPORTANT

- Read instructions carefully before operation.
- The unit should be operated when the room temperature is between 64°F (18°C) to 95°F (35°C). If the room temperature is below 64°F (18°C), ice may form on the coils. If the room temperature is above 95°F (35°C), the compressor will automatically shut off to protect itself.
- Always wait 3 minutes to restart after turning unit off.

▲ WARNING

- NEVER expose infants, handicapped persons, or senior persons directly to the airflow. Adjust the airflow direction.
- Keep children away from unit. Children are particularly liable to this danger. The fan is running at high speed inside. Covering it may deteriorate air conditioner performance or cause it to become inoperative.
- NEVER insert objects of any kind into the air intake or air outlet.
- DO NOT unplug if your hands are wet. An electrical shock may occur.
- DO NOT operate in a wet location.
- ALWAYS plug into 115V, 60Hz, single phase electrical outlet.
- Be sure plug fits receptacle securely.
- DO NOT run power cord under carpets, rugs, or floor mats of any kind.
- DO NOT attempt to shorten or alter power cord in any way.
- DO NOT apply any excessive force or pressure to the power supply cord.
- Make sure that the plug is free of dust.
- DO NOT use an extension cord.
- DO NOT turn on and off by inserting or removing the plug which may cause electric shock or fire.
- If there is a fear of lightning, stop the unit and disconnect the power supply cord.
- DO NOT touch the evaporator, condenser and pipes.
- DO NOT operate with filter removed.
- ALWAYS lift the unit with two people.

▲ CAUTION

- Keep unit more than 20 in. (50 cm) away from any objects or wall. (Fig. D)
- If the unit is operated in COOL mode in an area of very high moisture, the top plate and the rear plate may get covered with a mist. Wipe off any mist before it has a chance to get on the floor or rug.
- Remove drain water before moving unit.
- To minimize corrosion, DO NOT use in damp, salty air area.
- DO NOT operate in direct sunlight.
- DO NOT use for such particular purpose as preservation of foodstuff, animals, plants, precision appliances, arts and medicine.
- DO NOT place any animals, plants or combustion equipment in a place which is subjected to the direct air blow of the unit.
- DO NOT ride or place objects on the unit.
- DO NOT turn the unit on its side or upside down.

3. OPERATION

BEFORE OPERATION: INSTALLING FILTERS

▲ CAUTION

- Be sure to assemble the filters before using the unit.
1. Pull the air intake grille (B1) toward you and remove it.
 2. Take the HAF filter (B2) and the charcoal filter (B3) out of the plastic bag.
 3. Install the HAF filter (B2) and the charcoal filter (B3) by mounting the filter clamp (B4).

REMOTE CONTROL (Removable) (A1)

NOTE: This remote control can be stored on the top of the unit.

1. INSERTING BATTERIES

Remove the cover on the back of the remote control and insert the batteries with the (+) and (-) poles pointing in the proper direction. (Fig. H)

▲ CAUTION

- Use only AAA or IEC R03 1.5V batteries
- DO NOT attempt to recharge the supplied batteries.
- All batteries should be replaced at the same time.
- DO NOT dispose of the batteries in a fire as they may explode.
- DO NOT install the batteries with the polarity (+/-) reversed.
- Keep batteries and other things that could be swallowed away from young children. Contact a doctor immediately if an object is swallowed.

2. SET CLOCK

Press CLOCK button (C7), LCD clock display flashes. Press UP button "▲" (C10) or DOWN button "▼" (C4). In every holding second, LCD clock display changes setting by 1 minute interval.

Press UP button "▲" (C10) or DOWN button "▼" (C4) and holding more than 1 second, the LCD clock display changes setting by 30 minutes interval.

When complete setting, press CLOCK button (C7) again to confirm the setting. LCD CLOCK display stops flashing.

3. TEMPERATURE DISPLAY

By pressing C/F toggle button (C9), the display will toggle between Celsius and Fahrenheit.

4. SYNCHRONIZING FREQUENCY OF REMOTE CONTROL WITH UNIT (If necessary)

▲ CAUTION:

If the unit does not receive the signal from the remote control, synchronize the frequency of the remote control with the unit in accordance with the following procedure.

Hold the emergency ON/OFF switch (A5) more than 8 seconds continuously (it sounds at 4 seconds interval) after plugging into the electrical outlet and press the Power button (C1) of the remote control once. You will hear the beep and then the unit can receive the signal from the remote control.

LCDI (Leakage Current Detection and Interruption) PLUG

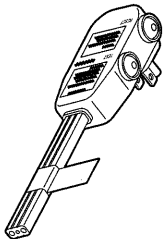

TEST: WHEN CURRENT LEAKING OR PRESSING TEST BUTTON, THE INDICATOR LIGHT WILL TURN OFF AND THE UNIT WILL CUT OUT.

RESET: AFTER SOLVING THE PROBLEM PLEASE PRESS RESET BUTTON.

ALWAYS: MAKE SURE THE INDICATOR LAMP IS ON AFTER PLUGGING INTO THE POWER. IF NOT, PRESS RESET BUTTON UNTIL IT CLICKS AND INDICATOR LAMP COMES ON.

HARD TO RESET BUTTON:
PRESSING BUTTON WITH A STICK SUCH AS PENCIL OR BALL POINT PEN WITH THE FLAT END (NOT SHARP EDGE) MAY MAKE IT EASIER TO RESET BUTTON.

NO POWER ON THE UNIT: MAKE SURE THE INDICATOR LAMP IS ON.

OPERATING STEPS:

1. DIRECT OPEN AIR OUTLET GRILLE UPWARD UNTIL IT LOCKS.

You can select the two levels, wide or narrow.
WARNING: Never use with closed air outlet grille.

2. PRESS POWER BUTTON (C1) TO "ON".

The unit starts the operation.

3. PRESS MODE BUTTON (C3).

Press the mode button (C3) to set your desired operation mode "COOL", "DEHUMIDIFY", "FAN" or "AUTO".

COOLING Mode

During the "COOL" mode the air is cooled and hot air is exhausted to the outside air through the exhaust duct hose. Adjust fan speed and temperature to suit your desired comfort level.

NOTE: The exhaust duct hose must vent outside the room when using Cooling Mode.

DEHUMIDIFYING Mode

Air is dehumidified as it passes through the unit, without being in full cooling mode.

The fan will operate in med speed. Fan speed is not adjustable in Dehumidifying mode operation.

FAN Mode

The "FAN" mode provides only circulation of room air, so that you cannot set the room temperature.

NOTE: The unit does not need to be vented in Fan mode.

AUTO Mode

To turn on the unit chooses "Auto" mode. The unit will switch its operation mode and fan speed automatically based on the environment temperature.

4. SET TEMPERATURE

Set the desired room temperature by pressing UP button "s" (C10) or DOWN button "t" (C4). The setting range is from 64°F (18°C) to 90°F (32°C). The display is set temperature only.

NOTE: When choosing AUTO, DEHUMIDIFY or FAN MODE, temperature setting button is invalid.

5. SET FAN SPEED

Press the fan speed button (C2) to set the desired air flow rate.

Auto [⊗] Operation at auto mode

High [☼] Operation at a high air flow

Med [☼] Operation at a medium air flow

Low [☼] Operation at a low air flow

6. AIR DEFLECTION (Fig. E)

The vertical louver (A4) may be set on right and left manually in desired direction.

7. STOP OPERATION

Press the Power button (C1).

TIMER OPERATION

Press the TIMER button (C8) when the unit is on, comes to OFF Timer.

Press the TIMER button (C8) when the unit is off, comes to ON Timer.

Set the desired time by pressing UP button "▲" (C10) or DOWN button "▼" (C4) and press the TIMER button again. The blue LED will light in the Emergency ON/OFF switch.

To cancel OFF Timer or ON Timer, press the Power button (C1).

Timer setting range is 1 ~ 12 hours.

""00"" = No timer setting.

EMERGENCY ON/OFF SWITCH (LED SCREEN) (A5)

This switch is used when the unit needs temporary ON/OFF. When pressing the Emergency ON/OFF switch (A5), the unit starts operation. The operation mode and the fan speed mode are set at Auto.

Press the Emergency ON/OFF switch (A5) again, the unit stops operation.

LED SCREEN

LED screen indicates the operation mode, timer operation mode and warning.

The following is the detail of indications.

NOTE: Yellow LED presents Red/Green lights up simultaneously.

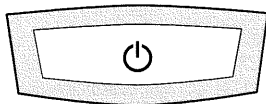

Operation mode

- Cooling mode (Blue)
- Dehumidify mode..... (Yellow)
- Fan mode (Green)

NOTE: Under AUTO mode, the unit will change its operation mode automatically.

OFF Timer Operation

- Cooling mode (Blue)
- Dehumidify mode..... (Yellow)
- Fan mode (Green)

NOTE: Under AUTO mode, the unit will change its operation mode automatically.

ON Timer Operation

All mode - Blue

Water tank full

If the water tank is full, red LED indicator flashes. When water tank is full, the unit stops operation. After removing the water from the tank, press the Power button to operate the unit and the unit will be in the mode before water tank is full.

Filter Cleaning Indicator

- Cooling mode (Blue)
- Dehumidify mode..... (Yellow)
- Fan mode (Green)

NOTE: When the filters have to be replaced, blue LED flashes in the Emergency ON/OFF switch. Display only when in operation mode.

Default Indicator

When default indicator lights on, internal wiring failure.

1. Upper part – Blue
 2. Lower part – Blue
- If get above 2 failures, please contact your dealer.

3. DRAINING EXCESS WATER (Fig. F)

1. Drain excess water from the tank by placing a pan under the drain water outlet. (F2)
2. Remove the drain plug, and let the water drain into the pan.
3. When the water stops draining out, replace the drain plug, put the tube back in the clip pointing up.
4. Remove the pan of water.
5. Operate the unit in Fan mode to dry the interior of the unit.

4. CLEANING

CLEANING AIR INTAKE GRILLE (Fig. G)

1. Clean the air intake grille (B1) once every two weeks.
2. To remove the air intake grille (B1), pull the grille off.
3. Remove the dust with a vacuum cleaner.

▲ WARNING: DO NOT touch the evaporator. It may cause injury or damage.

CLEANING SURFACE

Clean the outside of the unit with a soft damp cloth.

▲ CAUTION: NEVER use gasoline, solvents, chemical products or polish as they could damage the surfaces.

5. LONG-TERM STORAGE

At the end of the season, or when you do not plan to use the unit for an extended period of time, the following procedures are recommended.

1. Run the unit 5 or 6 hours with only the "FAN" mode operation in order to dry the inside.
2. Drain water from the tank.
3. Unplug the unit.
4. Clean the unit by wiping off any dirt or dust on the unit with a soft damp cloth or a vacuum cleaner, and then wipe again using a soft dry cloth.
5. Clean the air intake grille (B1) and replace it.
6. Store the unit. Exhaust dusts can be put in the rear panel. The original shipping carton is the best place to store the unit. If you do not have the original packing materials, cover the unit with a large plastic bag and store in a cool dry place.

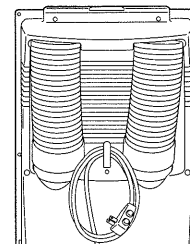

▲ CAUTION: ALWAYS store the unit in the vertical position. DO NOT put heavy objects on top of the unit.

6. TRANSPORTATION

Preferably keep the unit in the vertical position during transportation. If this is not possible then lay it on its rear side, when at destination put the unit back in the vertical position and wait at least ten (10) minutes before using it. Before transporting/moving the unit make sure the drain tank is empty.

▲ CAUTION: ALWAYS lift the unit with two people.

7. TROUBLESHOOTING

SYMPTOM	CAUSE	SOLUTION
Unit does not work.	- Power cut. - The plug has not been plugged properly. - The full-tank indicator is ON. Tank is full.	- Wait for power to be supplied again. - Plug in again. - Remove the drain water from the drain tank.
Unit suddenly stops during in operation.	- The indoor temperature has reached the set temperature level. - The preset time is up. - The full-tank indicator is ON. Tank is full.	- Reset the temperature level. - Reset the timer. - Remove the drain water from the drain tank.
Unit runs intermittently.	- Malfunction. - Surrounding temperature is too high or too low. - Exhaust duct hose is blocked.	- Contact your dealer. - Check the duct hose.
Unit functions but the room is not cooled.	- Window or door is left open in the room. - There is heat source in the room or too many of people in it. - Air intake grille is clogged. - Filter is too dirty. - Temperature setting is too high.	- Close all windows and door. - Move out any heat source in the room. - Clean the air intake grille. - Replace the filter. - Lower the temperature setting.
Condensed water is spilled out when moving the unit.	- The tank is nearly full.	- Remove the drain plug on the rear bottom of the unit, drain off the water then the unit will be in operation automatically.

BEFORE CALLING FOR SERVICE

The following are not defects.

A hissing noise or hollow sound :	⇒ This sound is generated from the refrigerant flowing within pipes.
A squeaking noise :	⇒ This noise is generated from the unit when it is expands or contracts with temperature changes.
Odor :	⇒ Such odor as tobacco, cosmetics, or foods may accumulate in the unit.
The unit does not start nor change operation mode immediately :	⇒ To prevent overloading the compressor motor, the unit will be stopped for more than 3 minutes.

8. SPECIFICATIONS

MODEL	TAD-T32G
COOLING CAPACITY	12,000 BTU/H
DEHUMIDIFYING CAPACITY	0.58 gal/h (2.2 L/H)
POWER SOURCE	Single Phase 115V, 60Hz
POWER CONSUMPTION	1,185 W
OPERATING CURRENT	10.5 A
AIR FLOW (MAX.)	250 CFM (425 m ³ /h)
OPERATING TEMP. RANGE	64°F~95°F (18°C~35°C)
DIMENSIONS (W × H × D)	20" × 36" × 16-1/2" (508 × 915 × 418 mm)
WEIGHT	84 Lbs. (38 kg)
COMPRESSOR	ROTARY
REFRIGERANT	R-22

NOTE: Cooling capacity will vary according to temperature and humidity of the room.

9. VENTING KIT ACCESSORIES

If the unit is to be used exclusively in one space, the cooling efficiency will be enhanced by using the following venting kit accessories.

EXHAUST DUCT SET (FLEXIBLE TUBE) (Fig. I)

2 pcs.
Max. 4 ft. (1.2m)

WINDOW PANEL KIT "C" (Fig. J)

Window panel kit "C"
For sliding and double-hung windows
Max. 37 in. (94cm)
Min. 28-1/4 in. (72cm)

USING EXHAUST DUCT SET (Fig. I)

1. Insert both ends of exhaust duct hose (flexible tube) (I2) into exhaust duct hose adapter nozzles (I1) by twisting counterclockwise until it stops.
2. Fix one of the exhaust duct hose adapter nozzles onto the rear outlet of the unit. This is achieved by sliding the exhaust duct hose adapter nozzle of the hose downwards over the exhaust outlet of the unit ensuring that lugs on the exhaust duct hose adapter nozzle are engaged with the grooves on the connector of the unit.
3. Extend the exhaust duct hose (I2) and close the window or door as far as possible trapping the exhaust duct hose adapter nozzle (I1).

NOTE: Place the unit as close as possible to the window or door.

USING WINDOW PANEL KIT (Fig. J)

NOTE: Window installations are possible by the use of the exhaust duct set and window panel kit.
In case of twin duct type, always use the window panel kit "C".

1. Fix the exhaust duct hose adapter nozzle (I1) to the window panel with four (4) screws. Make sure that the panel is extended so that screws do not go into sliding portion of panel.
- NOTE:** In case of twin duct type, fix the two exhaust duct hose adapter nozzles.
2. Insert the end of the exhaust duct hoses (I2) into the exhaust duct hose adapter nozzles (I1) by twisting it counterclockwise until it stops.
3. Open the window.
4. Place the window panel in the window, extending it to fit the width of the window. Once panel is extended, the panel can be locked into this width by tightening the two (2) screws on the top panel.
5. Close the window.
6. Place the exhaust duct hose grille (J3) on the exhaust duct hose adapter nozzle (I1).
7. When not in use, the exhaust duct hose adapter nozzle (I1) may be closed off with the cover (J4) for exhaust duct hose grille (J3) provided.

NOTE: The same procedure can be adapted for vertical installation in sliding windows.

OPTIONAL ACCESSORIES

When you need a longer size window panel, please purchase the extension window panel "B" and use it with the original window panel "C".

Part # 22740286 EXTENSION WINDOW PANEL "B" (M)
31-1/2" (80 cm)



Part # 22740288 EXTENSION WINDOW PANEL "B" (L)
56" (142 cm)



Part # 22740255 AIR OUTLET NOZZLE

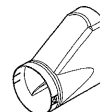

PARTS LIST

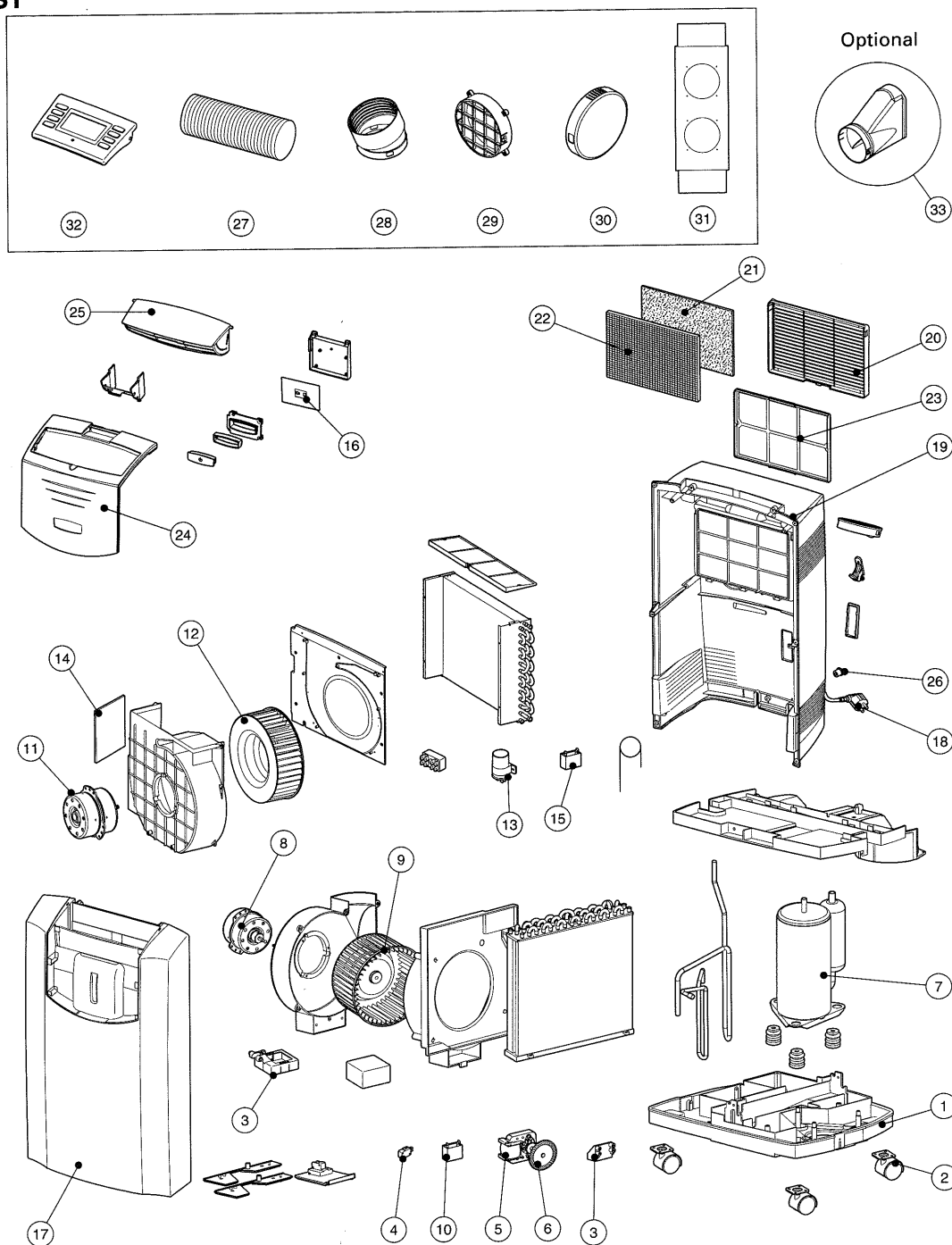

REF#	PART #	DESCRIPTION	REF#	PART #	DESCRIPTION	REF#	PART #	DESCRIPTION
1	22740429	Base pan assembly	13	22740447	Capacitor B	25	22740444	Air outlet grille
2	22740270	Caster	14	22740412	Main circuit board	26	22740480	Drain cap
3	22740230	Float	15	22740448	Capacitor C	27	22740449	Exhaust duct hose
4	22740206	Micro switch	16	22740417	Indication lamp circuit	28	22740254	Exhaust duct hose adapter nozzle
5	22740422	Drain motor	17	22740427	Front panel	29	22740253	Exhaust duct hose grille
6	22740223	Blade	18	22740435	Power supply cord	30	22740252	Cover
7	22740413	Compressor	19	22740451	Rear panel	31	22740481	Window panel kit "C"
8	22740420	Rear fan motor	20	22740445	Intake air grille	32	22740476	Remote control
9	22740442	Rear fan	21	22740403	HAF filter	33	22740255	Air outlet nozzle
10	22740446	Capacitor A	22	22740440	Charcoal filter	34	22740495	Instruction manual
11	22740418	Front fan motor	23	22740443	Filter clamp	35	22740499	Carton
12	22740441	Front fan	24	22740428	Front cover			

LIMITED WARRANTY

TOYOTOMI CO., LTD. ("TOYOTOMI") warrants each product and any parts thereof sold by it to be free from defects in materials or workmanship under normal use and service for TWELVE (12) MONTHS from the date of delivery to the original purchaser at retail subject to the following terms and conditions :

WHAT IS COVERED : Product or any parts thereof which are defective in materials or workmanship.

WHAT IS NOT COVERED :

This warranty does not extend to any defect due to the negligence of others; failure to install, operate or maintain unit in accordance with instructions (operating and maintenance instructions are furnished with each new unit); unreasonable use, accidents, alteration, use of unauthorized or non-standardized TOYOTOMI parts and accessories; electrical malfunction, i.e., as resulting from large power surges, short circuit, etc.; incorrect installation; or repair by anyone other than a service facility specified by TOYOTOMI.

WHO IS COVERED : The original purchaser at retail.

WHAT WE WILL DO : TOYOTOMI will either repair or replace, at its option, all defective parts free of charge that are covered by this limited warranty on a carry-in basis, to your nearest authorized dealer or distributor of TOYOTOMI.

WHAT YOU MUST DO FOR WARRANTY SERVICE : You must return the defective Product or part to any authorized dealer or distributor of TOYOTOMI with this LIMITED WARRANTY and a copy of your bill of sale or credit card charge receipt or other document evidencing the date of the Product's delivery. If service is not available locally, please contact our CUSTOMER RELATIONS DEPARTMENT at :

SHILAC ENTERPRISES INC.
23848 Hawthorne Blvd. (#100)
Torrance CA 90505
(310)791-2855

TOYOTOMI U.S.A., INC.
604 Federal Road, Brookfield, CT 06804
(203)775-1909

THE FOREGOING EXPRESSES ALL OF TOYOTOMI'S OBLIGATIONS AND LIABILITIES WITH RESPECT TO THE QUALITY OF PRODUCT FURNISHED BY IT. ALL OTHER WARRANTIES, EXPRESSED OR IMPLIED, INCLUDING THE WARRANTIES OF MERCHANTABILITY OR FITNESS FOR A PARTICULAR PURPOSE ARE DISCLAIMED. TOYOTOMI SHALL NOT BE LIABLE FOR THE LOSS OF USE OF THE PRODUCT, INCONVENIENCE, LOSS OR ANY OTHER DAMAGES, DIRECT OR CONSEQUENTIAL ARISING OUT OF, THE USE OF, OR INABILITY TO USE, THE PRODUCT OR DAMAGES RESULTING FROM OR ATTRIBUTABLE TO DEFECTS IN THE PRODUCT.

No other than TOYOTOMI has authority to extend or modify the terms of this Limited Warranty in any manner whatsoever.

Some states do not allow the exclusion or limitation of incidental or consequential damages or limitations on how long an implied warranty lasts, so these limitations or exclusions may not apply to you. This Limited Warranty gives you specific legal rights and you may also have other rights which vary from state to state.